

## Prefabricated Module 20 sqm (Allows coupling and Stecking of more units)

### LOAD BEARING FRAME:

Load bearing frame made of galvanized steel, thickness 20/10;

### FLOORING SYSTEM:

Flooring system made of wooden panels, thickness 18 mm, on which a linoleum sheet is glued;

### SIDWARD "SANDWICH" PANELS:

Sandwich insulated panels, thickness 40/80 mm;

### DOOR/WINDOWS FRAME:

- N° 1 External Blind/Half Glass door;
- N° 2 Window in ALL/PVC;
- N° 2 Conditioner-Holder in ALL/PVC;
- N° 3 Internal Blind Door;
- N° 1 Vasistas Window;

### ELECTRICAL SYSTEM:

- N° 1 Patch box;
- N° 2 Ceiling light;
- N° 2 Round Ceiling light;
- N° 4 Switch;
- N° 3 Socket 10/16A

### PLUMBING:

- N° 1 Shower base, dim.720X720 mm, with mixer tap and shower dispenser;
- N° 1 W.C. with wall waste pipe;
- N° 1 Sinks in ceramic;
- N° 1 Boiler;

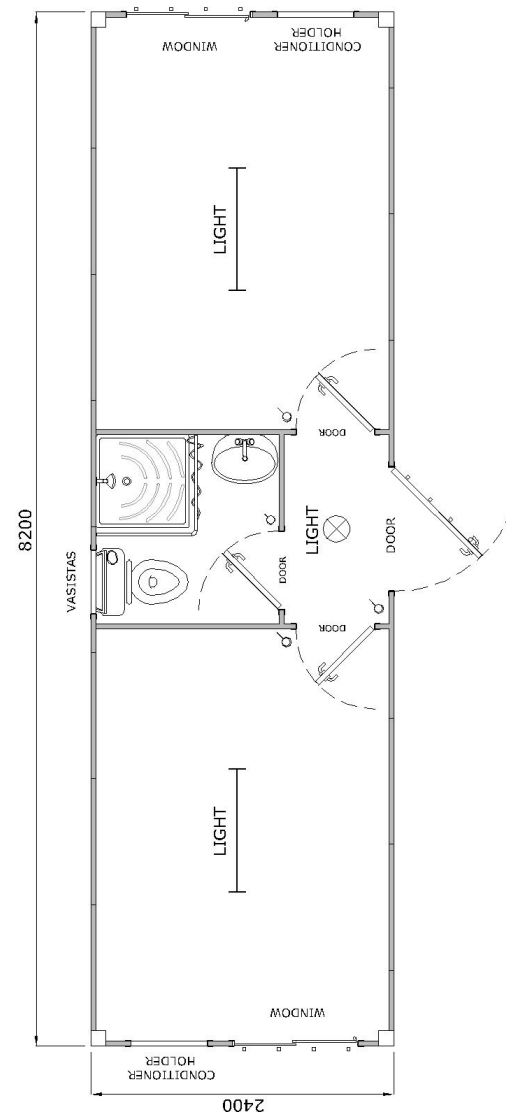

H int.: 2.40/2,70 m.  
H est.: 2.70/2,99 m.